

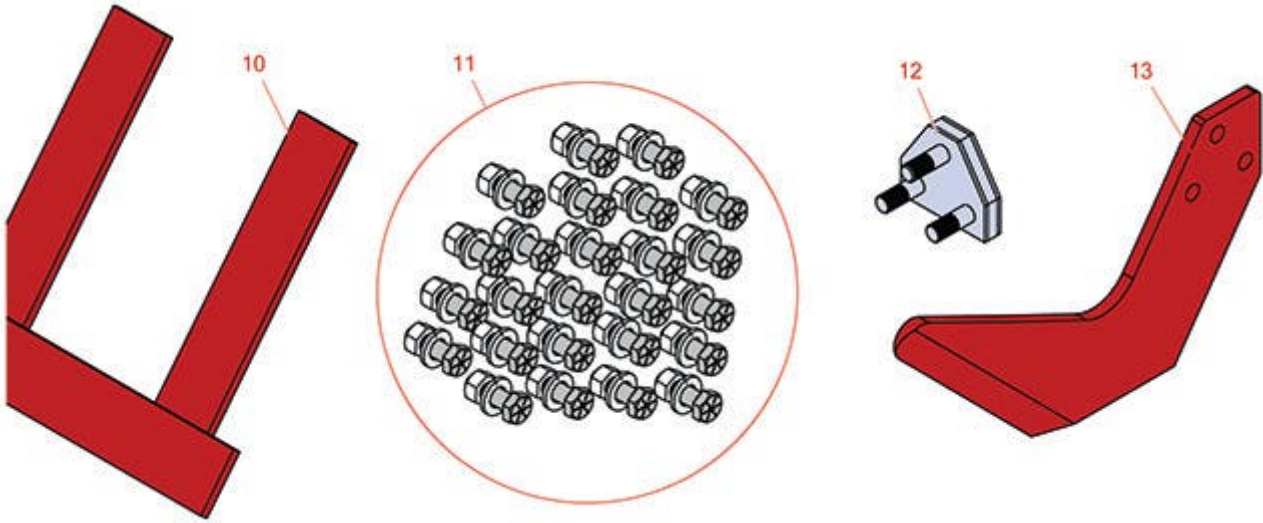

# Replaces Beck Sod Harvester Parts

*Sod Harvester Blades*

*Blade Options and Hardware*



All original equipment manufacturers names and part numbers are used for identification purposes only, and we are in no way implying that our products are original equipment parts. Prices subject to change without notice.



# Replaces Beck Sod Harvester Parts

Sod Harvester Blades

Blade Options and Hardware



Item No	R&R Part No.	OEM Part No.	Description	Qty Req	Order Quantity
---------	--------------	--------------	-------------	---------	----------------

## Sod Blade Fingers

10	R250393		Finger - Sod Blade 3/16 x 1-1/4 x 5-1/2	0	
----	---------	--	---	---	--

*Detail Description: Fingers available on all blades. Specify number of fingers when ordering. 4 fingers std. on 16" & 18" and 5 fingers std. on 24" Blades. Minimum 10 blades for custom fingers or hole sizes. All sales final.:*

## Hardware

11	R250405		Bolt Kit - 5/16 x 1 w/Nut Set/25	0	
----	---------	--	----------------------------------	---	--

*Detail Description: 5/16" X 1" Grade 8 Hardened Bolt with Lock Washer & Lock Nut - Pkg of 25:*

11	R250406		Bolt Kit - 5/16 x 1 w/Whiz Nut Set/25	0	
----	---------	--	---------------------------------------	---	--

*Detail Description: 5/16" X 1" Grade 8 Hardened Bolt with Whiz Nut - Pkg of 25:*

12	R250409		Sod Bolt - Fast Attach	0	
----	---------	--	------------------------	---	--

*Detail Description: Includes 3 Bolt Assemblies and Nuts:*

## Special End Plate Hole Sizes

13	R250415		Endplate - Sod Blade - Special Hole (3/8 or 7/16)	0	
----	---------	--	---	---	--

*Detail Description: Minimum 10 blades for special endplate hole size - All sales final:*

All original equipment manufacturers names and part numbers are used for identification purposes only, and we are in no way implying that our products are original equipment parts. Prices subject to change without notice.