

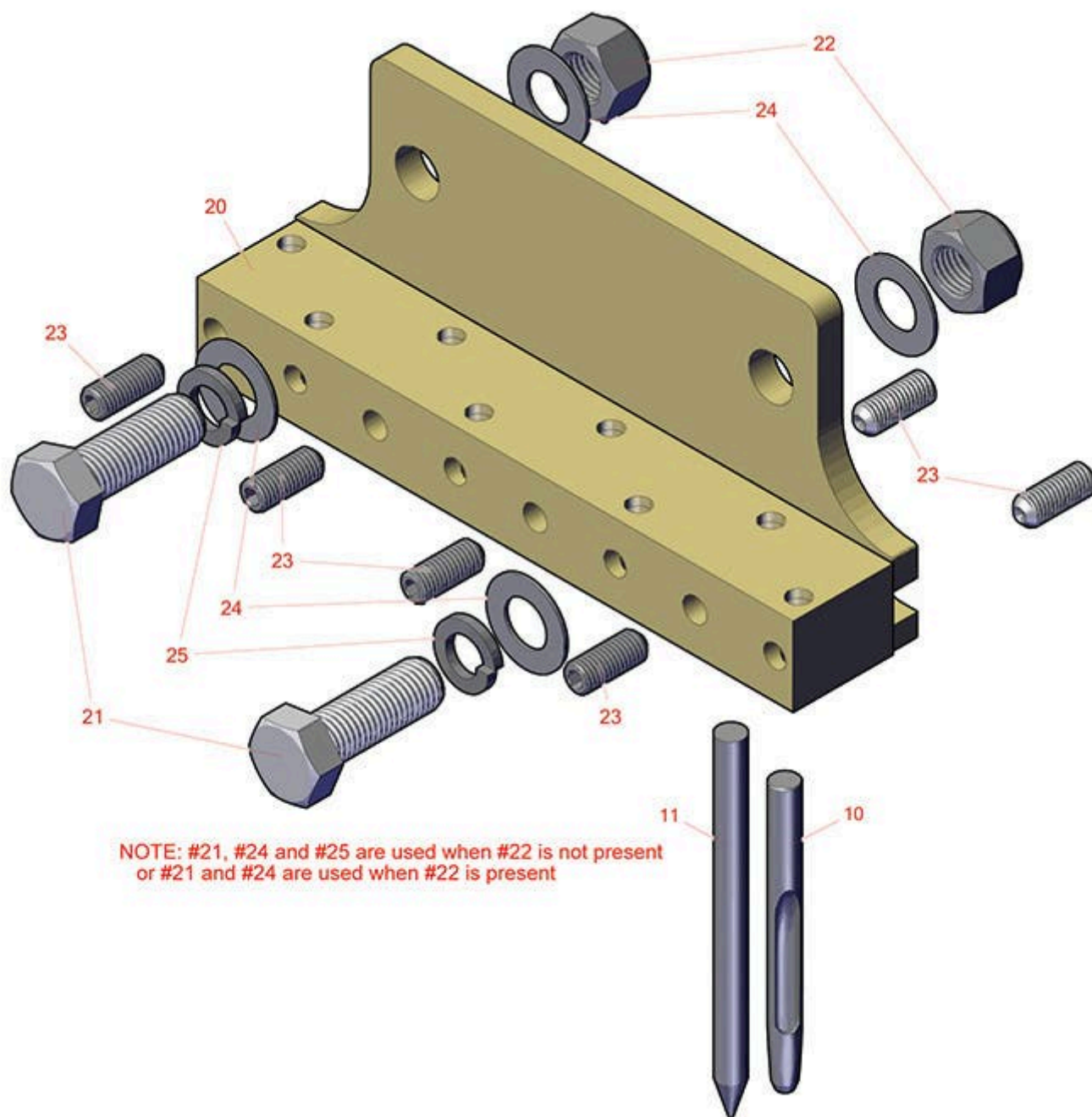

# Replaces Toro ProCore 660 Parts

Aerating Unit

Mini Tine Head - Model 09721



NOTE: #21, #24 and #25 are used when #22 is not present  
or #21 and #24 are used when #22 is present

NOTE: TINES NOT SUPPLIED WITH KIT



# Replaces Toro ProCore 660 Parts

Aerating Unit

Mini Tine Head - Model 09721



Item No	R&R Part No.	OEM Part No.	Description	Qty Req	Order Quantity
---------	--------------	--------------	-------------	---------	----------------

## Tines

10	<b>R100-3625</b>	100-3625	Alloy Machined Side-Eject Tine - .375MT x 4.000L x .350OD	8	
----	------------------	----------	---	---	--

*Detail Description: Alloy Machined Side-Eject tines remove a soil core which quickly exits the side of the tine through a precision machined slot. This slot is designed to avoid "plugging" that can occur using hollow tubular tines (especially the smaller diameters) in heavy soil conditions. R&R manufactures a wide selection of these side-eject tines machined from special high-carbon alloy steel solid bar and heat treated to RC45-48 in our own heat treating facility. Very popular for the multiple tine holders which fit all greens aerators.:*

10	<b>R201632</b>	108-9105	Alloy Machined Side-Eject Tine - .375MT x 4.500L x .450OD	8	
----	----------------	----------	---	---	--

*Detail Description: Alloy Machined Side-Eject tines remove a soil core which quickly exits the side of the tine through a precision machined slot. This slot is designed to avoid "plugging" that can occur using hollow tubular tines (especially the smaller diameters) in heavy soil conditions. R&R manufactures a wide selection of these side-eject tines machined from special high-carbon alloy steel solid bar and heat treated to RC45-48 in our own heat treating facility. Very popular for the multiple tine holders which fit all greens aerators.:*

11	<b>R100-3622</b>	100-3622	Alloy Solid Tine - .375MT x 5.000L x .375OD	8	
----	------------------	----------	---	---	--

*Detail Description: Alloy Solid Tines aerate without the work of cleaning up the mess of cores and debris left behind with conventional core aerating. R&R Solid Tines are manufactured from a special high-carbon steel bar and heat treated to RC45-48 in our own heat treatment facility. They are available in all standard sizes but are especially popular in the smaller diameters for aerating in the summer months to relieve the stress on greens by allowing water, air and nutrients to easily flow into the root zone. With the combination of small holes and no cores, play can be resumed immediately.:*

11	<b>R108-9233</b>	108-9233	Alloy Solid Tine - .375MT x 4.500L x .350OD	8	
----	------------------	----------	---	---	--

*Detail Description: Alloy Solid Tines aerate without the work of cleaning up the mess of cores and debris left behind with conventional core aerating. R&R Solid Tines are manufactured from a special high-carbon steel bar and heat treated to RC45-48 in our own heat treatment facility. They are available in all standard sizes but are especially popular in the smaller diameters for aerating in the summer months to relieve the stress on greens by allowing water, air and nutrients to easily flow into the root zone. With the combination of small holes and no cores, play can be resumed immediately.:*

## Other Parts Available

All original equipment manufacturers names and part numbers are used for identification purposes only, and we are in no way implying that our products are original equipment parts. Prices subject to change without notice.



## Replaces Toro ProCore 660 Parts

*Aerating Unit*

*Mini Tine Head - Model 09721*



Item No	R&R Part No.	OEM Part No.	Description	Qty Req	Order Quantity
20	<b>R100-3693</b>	100-3693	Tine Holder - Mini 8 Tine 3/8 Mt	1	
21	<b>R33118-045</b>	33118-045	Bolt - Hex HD M16-2.0 x 45	2	
22	<b>R33028-00</b>	33028-00	Locknut - 16mm x 2.0 ESNA	2	
23	<b>R100-3694</b>	100-3694	Screw - Set - 10mm x 1.5 x 25mm	8	
24	<b>R33096-00</b>	33096-00	Washer-Flat	2	
24	<b>R33098-00</b>	33098-00	Flatwasher - 16mm	2	
25	<b>R3253-7</b>	01-166-0030, 01-166-0080, 01-166-0290, 01-166-0810, 23-13-GD, 3253-7, 48-9380	Washer - Lock 1/2	2	

All original equipment manufacturers names and part numbers are used for identification purposes only, and we are in no way implying that our products are original equipment parts. Prices subject to change without notice.