

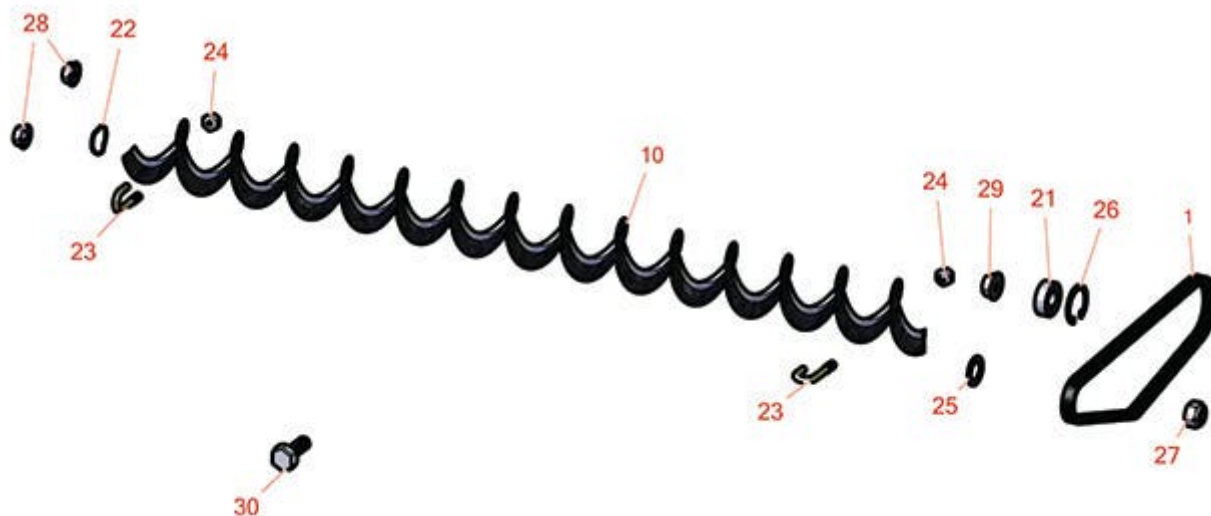

# Replaces Toro Greensmaster eTriFlex 3360 Parts

*DPA Cutting Unit - Models 04651, 04653 & 04655*

*Rear Roller Brush - Model 04650*



All original equipment manufacturers names and part numbers are used for identification purposes only, and we are in no way implying that our products are original equipment parts. Prices subject to change without notice.



# Replaces Toro Greensmaster eTriFlex 3360 Parts



DPA Cutting Unit - Models 04651, 04653 & 04655  
Rear Roller Brush - Model 04650

Item No	R&R Part No.	OEM Part No.	Description	Qty Req	Order Quantity
---------	--------------	--------------	-------------	---------	----------------

## Belts

1	<b>R105-5720</b>	105-5720	Belt - Poly V	1	
---	------------------	----------	---------------	---	--

## Rollers

10	<b>R105-6792</b>	104-1829, 105-6792	Brush - Rear Roller	1	
----	------------------	-----------------------	---------------------	---	--

## Other Parts Available

21	<b>R251-259</b>	251-259, 251-307	Bearing - Ball	1	
----	-----------------	---------------------	----------------	---	--

22	<b>R115-7143</b>	115-7143	Spring - Wave	1	
----	------------------	----------	---------------	---	--

23	<b>R104-1830</b>	104-1830	Bolt - J	2	
----	------------------	----------	----------	---	--

24	<b>R3296-2</b>	32127-10, 3296-2, 9157404	Nut - #10 Lock	2	
----	----------------	---------------------------------	----------------	---	--

25	<b>R112-6957</b>	112-6957	Washer - Hardened	2	
----	------------------	----------	-------------------	---	--

26	<b>R104-4727</b>	104-4727	Ring - Retaining	1	
----	------------------	----------	------------------	---	--

27	<b>R121-4600</b>	121-4600	Locknut - 3/8-16 Hx HD Jam Nylon Ins	1	
----	------------------	----------	--------------------------------------	---	--

28	<b>R32128-33</b>	32128-33	Nut - 1/4-20 Flanged Serr	2	
----	------------------	----------	---------------------------	---	--

28	<b>R301504</b>	2296-42, 301504, 32127-24, 32128-33, 32146-17, 3296-16, 3296-42, 3296-42 , 915661P	Locknut - ESNA 1/4-20	2	
----	----------------	--	-----------------------	---	--

29	<b>R104-8300</b>	104-8300, 104-8300 , 119-4041	Locknut - 5/16-18 Flanged Y/Zinc	5	
----	------------------	-------------------------------------	----------------------------------	---	--

All original equipment manufacturers names and part numbers are used for identification purposes only, and we are in no way implying that our products are original equipment parts. Prices subject to change without notice.



# Replaces Toro Greensmaster eTriFlex 3360 Parts



*DPA Cutting Unit - Models 04651, 04653 & 04655*  
*Rear Roller Brush - Model 04650*

Item No	R&R Part No.	OEM Part No.	Description	Qty Req	Order Quantity
30	R3234-29	3234-17, 3234-29	Bolt - 5/16-18x1 Serr Hex	1	

All original equipment manufacturers names and part numbers are used for identification purposes only, and we are in no way implying that our products are original equipment parts. Prices subject to change without notice.