

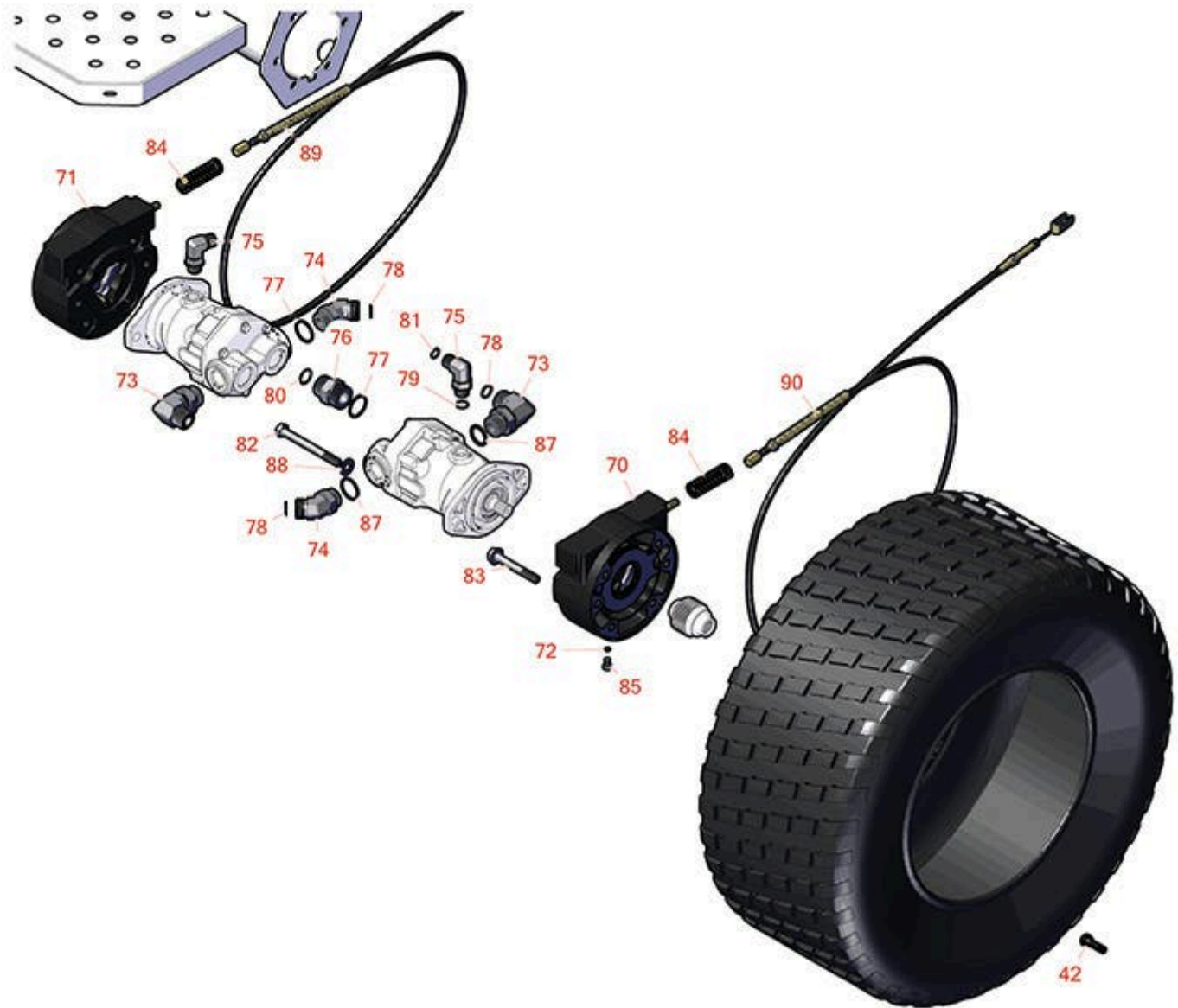

Replaces Toro Reelmaster 7000-D Parts

Traction Unit - Model 03780

Front Wheel Brake



All original equipment manufacturers names and part numbers are used for identification purposes only, and we are in no way implying that our products are original equipment parts. Prices subject to change without notice.



Replaces Toro Reelmaster 7000-D Parts

Traction Unit - Model 03780

Front Wheel Brake



Item No	R&R Part No.	OEM Part No.	Description	Qty Req	Order Quantity
---------	--------------	--------------	-------------	---------	----------------

Tires & Wheels

0	TIRES		Click Here to View Complete Tire Selection	0	
42	R232-24	232-24, 232-35	Stem - Valve w/ Cap	2	

Other Parts Available

70	R100-3070-03	100-3070-03	Brake Assy - LH	1	
71	R100-3069-03	100-3069-03	Brake Assy - RH	1	
72	R237-22	107-8844, 237-22, 237-78	O-Ring	1	
73	R340-142	340-142, 95-1692	Hydraulic Fitting - 90 Deg	2	
74	R100-5530	100-5530, 98-0657	Hydraulic Fitting - 45 Deg	2	
75	R340-98	340-98	Hydraulic Fitting	2	
76	R104-3797	104-3797	Hydraulic Fitting - Striaight	2	
77	R237-146	237-146, 340-146	O-Ring	2	
78	R237-58	237-58	O-Ring	4	
79	R237-79	237-79	O-Ring	2	
80	R340-65	340-65	O-Ring	2	
81	R237-30	23-6320, 237-30	O-Ring - Seal	2	
82	R33116-120	33116-120	Bolt - M12-1.75 x 120mm Hx HD	4	
83	R33106-090	33106-090	Bolt - M12-1.75 x 90 Fl Hex HD Gr 8.8	8	

All original equipment manufacturers names and part numbers are used for identification purposes only, and we are in no way implying that our products are original equipment parts. Prices subject to change without notice.



Replaces Toro Reelmaster 7000-D Parts

Traction Unit - Model 03780

Front Wheel Brake



Item No	R&R Part No.	OEM Part No.	Description	Qty Req	Order Quantity
84	R94-3088	94-3088	Spring - Compression	2	
85	R353-990	353-990	Plug	1	
87	R237-81	237-81, 237.81, 327-81	O-Ring	2	
88	R3256-26	01-166-0540, 01-166-0820, 17-2530, 24-13-BD, 30-8570, 3256-26, 356206, 48-9390	Washer - 1/2 in	4	
89	R92-7529	92-7529	Brake Cable Assy - RH	1	
90	R92-7530	92-7530	Brake Cable Assy - LH	1	

All original equipment manufacturers names and part numbers are used for identification purposes only, and we are in no way implying that our products are original equipment parts. Prices subject to change without notice.