

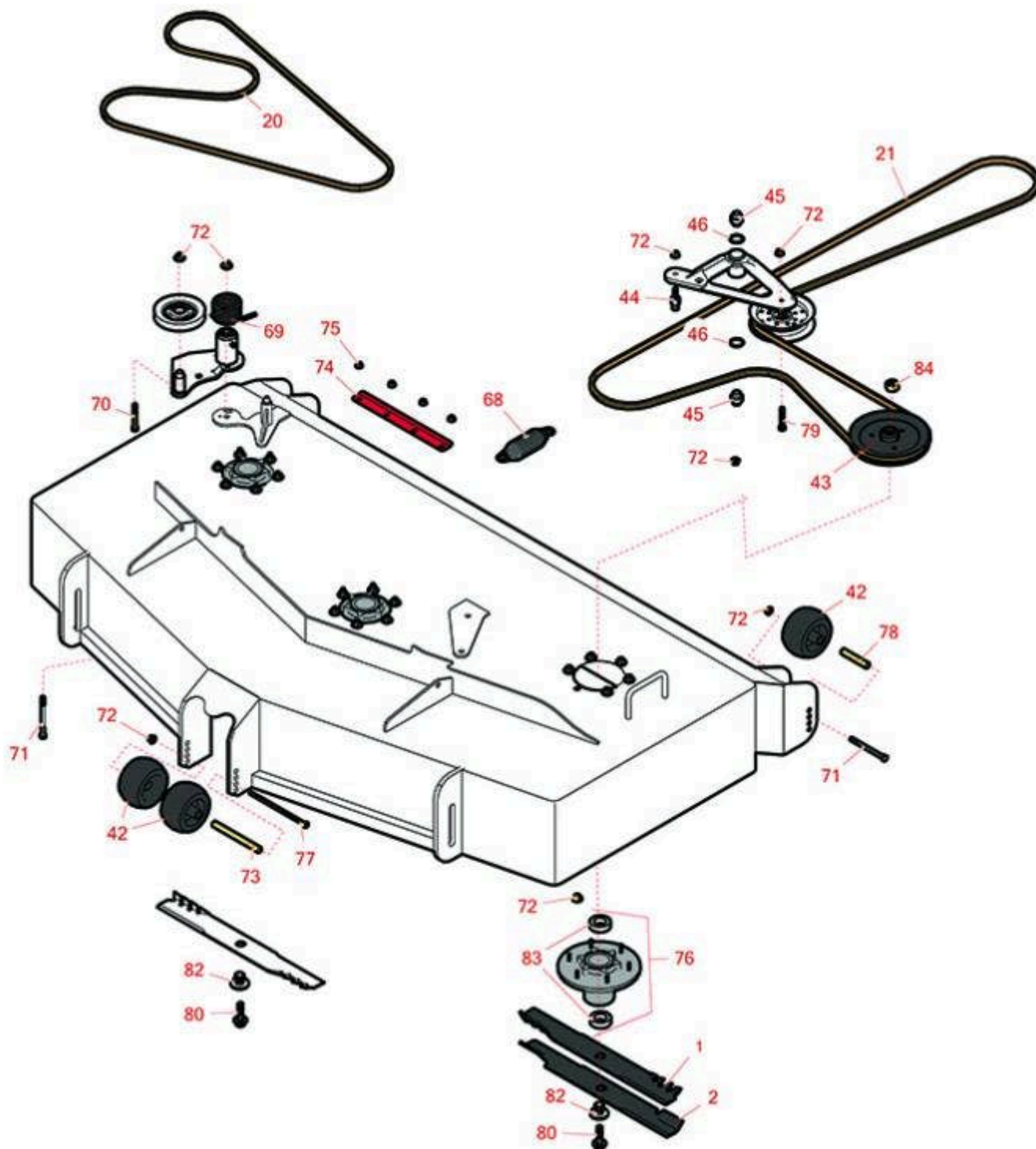

## Replaces Exmark Lazer Z E-Series Parts

Zero-Turn Mower with 60in Deck - Model LZE730GKA60RA1  
Deck Parts



All original equipment manufacturers names and part numbers are used for identification purposes only, and we are in no way implying that our products are original equipment parts. Prices subject to change without notice.



# Replaces Exmark Lazer Z E-Series Parts

Zero-Turn Mower with 60in Deck - Model LZE730GKA60RA1  
Deck Parts



Item No	R&R Part No.	OEM Part No.	Description	Qty Req	Order Quantity
1	<b>RRB4065-2001</b>	116-5174, 116-5174-S	Mower Blade - Mulcher 20.5 x 2.5in x 15/16 Mt Hole	2	
2	<b>RRB3065-2001</b>	103-6403, 103-6403-S	Mower Blade - High-Lift 20.5 x 2.5in x 15/16 Mt Hole	2	
<i>Detail Description: R&amp;R Products rotary blades are manufactured in the USA with superior alloy steel and hardened for extended life. Lifetime guaranteed against defects in material and workmanship.:</i>					
<b>Belts</b>					
20	<b>R116-8187</b>	116-8187	Belt - V - Deck	1	
21	<b>R125-9371</b>	125-9371	Belt - V - Deck	1	
<b>Tires</b>					
30	<b>R68-2730</b>	1-603299	Wheel - Anti Scalp	4	
<b>Other parts</b>					
43	<b>R116-0676</b>	116-0676	Sheave,blade Drive - 14T Spline Hub	3	
44	<b>R126-0423</b>	126-0423	Pin - Spring - Anchor	1	
45	<b>R103-3504</b>	103-3504	Bearing - Spherical	2	
46	<b>R106-7159</b>	106-7159	O-Ring	2	
68	<b>R116-6317</b>	116-0133, 116-6317	Spring - Extension	1	
69	<b>R108-1921</b>	108-1921	Torsion Spring - Idler	1	
70	<b>R323-13</b>	323-13	Bolt - Hex HD 3/8-16 x 2-3/4 GR5	1	
71	<b>R323-23</b>	323-23	Bolt - Hex HD 3/8-16 x 4-1/2	3	

All original equipment manufacturers names and part numbers are used for identification purposes only, and we are in no way implying that our products are original equipment parts. Prices subject to change without notice.



## Replaces Exmark Lazer Z E-Series Parts

Zero-Turn Mower with 60in Deck - Model LZE730GKA60RA1  
Deck Parts



Item No	R&R Part No.	OEM Part No.	Description	Qty Req	Order Quantity
72	<b>R104-8301</b>	104-8301, 109-6658	Locknut - 3/8-16 Nylon Flanged	31	
73	<b>R98-5967</b>	98-5967	Spacer-Wheel	1	
74	<b>R126-0413-01</b>	126-0413-01	Support - Outer Flap	2	
75	<b>R104-8300</b>	104-8300, 119-4041	Locknut - 5/16-18 Flanged Y/Zinc	15	
76	<b>R116-3344</b>	116-3344	Spindle Housing Assy	3	
77	<b>R108-5388</b>	108-5388	Bolt - Hx HD 3/8-16 x 7 1/2	1	
78	<b>R98-7912</b>	98-7912	Bushing - Spanner Wheel	2	
79	<b>R104-3396</b>	104-3396	Bolt - Hex HD 3/8-16 x 2-1/4	1	
80	<b>R109-9220</b>	109-9220	Bolt - Sems 1/2-20	3	
82	<b>R103-3037</b>	103-3037	Splined Bushing	3	
83	<b>R116-0720</b>	116-0720	Bearing - Ball - Special Triple Seal	6	
84	<b>R116-7306</b>	116-7306	Hex Nut - 3/4-16 with Nyloc	3	

All original equipment manufacturers names and part numbers are used for identification purposes only, and we are in no way implying that our products are original equipment parts. Prices subject to change without notice.