

Replaces Exmark Turf Tracer X-Series Parts

Walk Behind Mower - Model TTX691GKA52400 with 52in Deck
52in Deck Parts

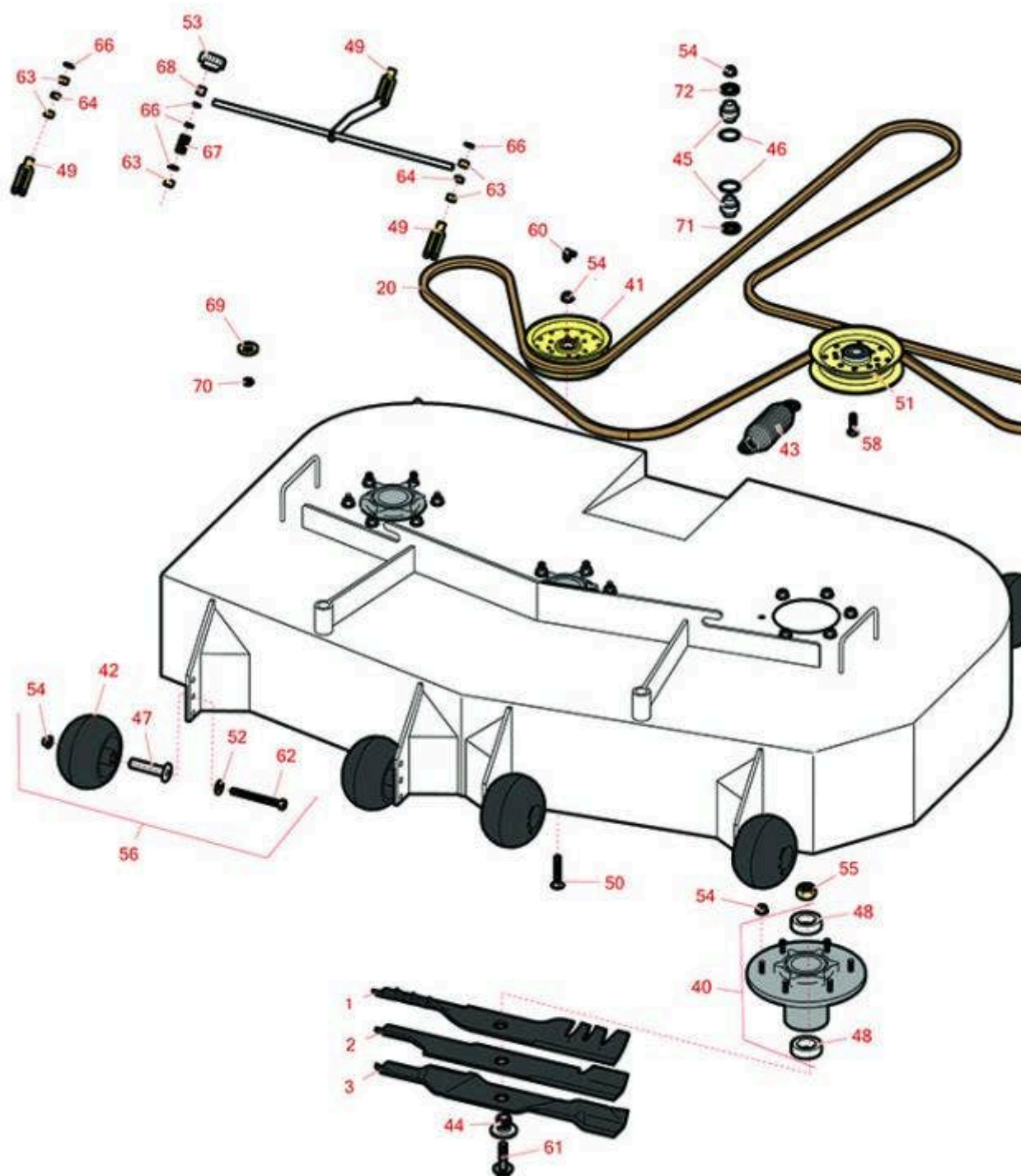

All original equipment manufacturers names and part numbers are used for identification purposes only, and we are in no way implying that our products are original equipment parts. Prices subject to change without notice.



Replaces Exmark Turf Tracer X-Series Parts

Walk Behind Mower - Model TTX691GKA52400 with 52in Deck
52in Deck Parts



| Item No | R&R Part No. | OEM Part No. | Description | Qty Req | Order Quantity |
|---|---------------------|--------------------------------------|---|---------|----------------|
| Rotary Blades | | | | | |
| 1 | R116-5175 | 116-5175 | Mower Blade - 18 in Mulching | 3 | |
| 1 | RRB4065-1803 | 116-5175, 116-5175-S | Mower Blade - Mulcher 18 x 2.5in x 15/16 Mt Hole | 3 | |
| 2 | RRB3065-1803 | 103-6402, 103-6402-S, 106-6402 | Mower Blade - High-Lift 18 x 2.5in x 15/16 Mt Hole | 3 | |
| <i>Detail Description: R&R Products rotary blades are manufactured in the USA with superior alloy steel and hardened for extended life. Lifetime guaranteed against defects in material and workmanship.:</i> | | | | | |
| 3 | RRB5360-1803 | 103-6392, 103-6392-S | Mower Blade - Wave Mulcher 18 x 2.5in x 15/16 Mt Hole | 3 | |
| Belt | | | | | |
| 20 | R126-2538 | 126-2538 | Belt- Deck Drive | 1 | |
| Other Parts Available | | | | | |
| 40 | R116-3344 | 116-3344 | Spindle Housing Assy | 3 | |
| 41 | R116-4669 | 116-4669 | Idler Pulley - Flat | 2 | |
| <i>Tech Note: Only for 2015 and 2016 years mdels:</i> | | | | | |
| 42 | R103-8415 | 103-8415 | Roller - Anti Scalp | 6 | |
| 43 | R116-6317 | 116-0133, 116-6317 | Spring - Extension | 1 | |
| 44 | R103-3037 | 103-3037 | Splined Bushing | 3 | |
| 45 | R103-3504 | 103-3504 | Bearing - Spherical | 2 | |
| 46 | R106-7159 | 106-7159 | O-Ring | 2 | |
| 47 | R116-8131 | 116-8131 | Axle - Roller | 6 | |

All original equipment manufacturers names and part numbers are used for identification purposes only, and we are in no way implying that our products are original equipment parts. Prices subject to change without notice.



Replaces Exmark Turf Tracer X-Series Parts

Walk Behind Mower - Model TTX691GKA52400 with 52in Deck
52in Deck Parts



| Item No | R&R Part No. | OEM Part No. | Description | Qty Req | Order Quantity |
|--|------------------|-------------------------------|--------------------------------------|---------|----------------|
| 48 | R116-0720 | 116-0720 | Bearing - Ball - Special Triple Seal | 6 | |
| 49 | R282-2 | 1-303105 | Yoke | 3 | |
| 50 | R3231-40 | 3231-40 | Bolt - Carriage 3/8-16 x 2 1/4 | 2 | |
| 51 | R126-9196 | 126-9196 | Idler Pulley - Flat | 1 | |
| <i>Tech Note: Only for 2024 model:</i> | | | | | |
| 52 | R98-5975 | 98-5975 | Washer - Belleville | 6 | |
| 53 | R103-3060 | 103-3060 | Knob - Tracking | 1 | |
| 54 | R104-8301 | 104-8301, 109-6658 | Locknut - 3/8-16 Nylon Flanged | 26 | |
| 55 | R116-7306 | 116-7306 | Hex Nut - 3/4-16 with Nyloc | 3 | |
| 56 | R116-9981 | 116-9981 | Kit - Anti-Scalp Roller | 6 | |
| 58 | R400264 | 323-29, 323-7 | Bolt - Hex HD 3/8-16 x 1-1/4 | 1 | |
| 60 | R302-40 | 302-40 | Fitting - Grease | 1 | |
| 61 | R109-9220 | 109-9220 | Bolt - Sems 1/2-20 | 3 | |
| 62 | R116-9362 | 116-9362 | Bolt - Hex HD 3/8-16 x 3 3/4 GR8 YZ | 6 | |
| 63 | R3219-2 | 3219-2 | Nut - 5/16-24 Zinc | 7 | |
| 64 | R3220-2 | 3220-2 | Nut - Jam - 5/16-24 | 2 | |
| 66 | R453009 | 3256-2, 3256-3, 3256-67 | Washer - Flat 5/16 SAE | 9 | |
| 67 | R1-323245 | 1-323245 | Spring - Compression | 1 | |
| 68 | R1-603903 | 1-603903 | Spacer | 1 | |

All original equipment manufacturers names and part numbers are used for identification purposes only, and we are in no way implying that our products are original equipment parts. Prices subject to change without notice.



Replaces Exmark Turf Tracer X-Series Parts

*Walk Behind Mower - Model TTX691GKA52400 with 52in
Deck*
52in Deck Parts



| Item No | R&R Part No. | OEM Part No. | Description | Qty Req | Order Quantity |
|---------|------------------|--------------|----------------------|---------|----------------|
| 69 | R1-323539 | 1-323539 | Spacer | 2 | |
| 70 | R3220-3 | 3220-3 | Nut - Jam Ball Joint | 2 | |
| 71 | R103-3505 | 103-3505 | Seal - Double Lip | 1 | |
| 72 | R103-3506 | 103-3506 | Seal - Single Lip | 1 | |

All original equipment manufacturers names and part numbers are used for identification purposes only, and we are in no way implying that our products are original equipment parts. Prices subject to change without notice.