

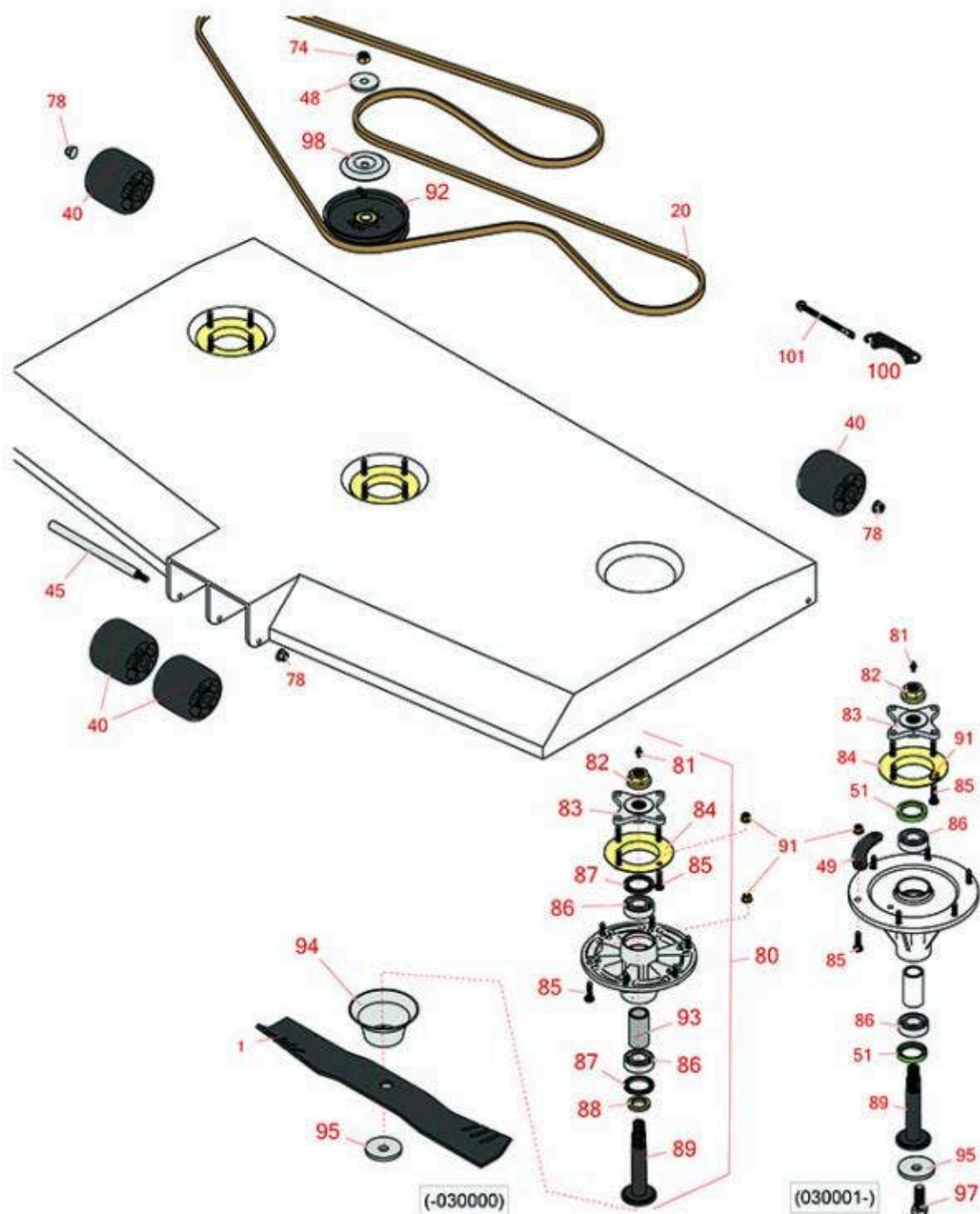

Replaces John Deere 1585 Rotary Mower Parts

Rotary Mower
62in Deck Parts



All original equipment manufacturers names and part numbers are used for identification purposes only, and we are in no way implying that our products are original equipment parts. Prices subject to change without notice.



Replaces John Deere 1585 Rotary Mower Parts

Rotary Mower
62in Deck Parts



| Item No | R&R Part No. | OEM Part No. | Description | Qty Req | Order Quantity |
|---------|--------------|--------------|-------------|---------|----------------|
|---------|--------------|--------------|-------------|---------|----------------|

Rotary Blades

| | | | | | |
|---|----------|----------------------|---|---|--|
| 1 | RM144935 | M144935, TCU51118 | Mower Blade - Mulcher - 22 x 3 x 1/4 in | 3 | |
|---|----------|----------------------|---|---|--|

Belts & Pullies

| | | | | | |
|----|----------|----------|-----------------------|---|--|
| 20 | RTC33435 | TCU33435 | Belt - V - 62 in Deck | 1 | |
|----|----------|----------|-----------------------|---|--|

Other Parts Available

| | | | | | |
|----|-----------|-----------------------|---|----|--|
| 40 | RM115245 | M115245 | Roller | 4 | |
| 45 | RM124203 | M124203 | Shaft | 1 | |
| 48 | RM132309 | M132309 | Spacer | 2 | |
| 49 | RTC39458 | TCU39458 | Plate - Spindle Mount Reinforcement | 9 | |
| 51 | R253-133 | M85699 | Seal - Oil | 6 | |
| 74 | R14M7401 | 14M7401 | Locknut - 12mm x 1.75 | 2 | |
| 78 | R14M7465 | 14M7465 | Lock Nut - M10-1.50 FI | 10 | |
| 80 | RTCA24881 | TCA24881 | Spindle - Includes RM134305; Sub For TCA51058; Housing Assembly | 3 | |
| 81 | R471217 | JD7803 | Fitting - Grease | 3 | |
| 82 | RM123569 | M123569 | Flange Nut | 3 | |
| 83 | RTC38142 | TCU14182, TCU38142 | Hub - Sub For TCU51119 or TCU14182 | 3 | |
| 84 | RTC51223 | TCU51223 | Deflector - Grass | 3 | |
| 85 | R19M7868 | 19M7868 | Bolt - M8-1.25 x 30 HHF | 30 | |
| 86 | RM88251 | M169375, M88251 | Bearing - Spindle | 6 | |
| 87 | RM127198 | M127198 | Seal | 6 | |

All original equipment manufacturers names and part numbers are used for identification purposes only, and we are in no way implying that our products are original equipment parts. Prices subject to change without notice.



Replaces John Deere 1585 Rotary Mower Parts

Rotary Mower
62in Deck Parts



| Item No | R&R Part No. | OEM Part No. | Description | Qty Req | Order Quantity |
|---------|--------------|------------------|---|---------|----------------|
| 88 | RM163060 | M133398, M163060 | Washer - Replaces RM133398 | 3 | |
| 89 | RM134382 | M134382 | Spindle - 25 mm w/M12-1.75 Blade Bolt Thrd | 3 | |
| 89 | RM163059 | M163059 | Spindle - 25 mm w/M16-2.0 Blade Bolt Thrd | 3 | |
| 91 | R14M7396 | 14M7396 | Locknut - Flanged Nyloc | 30 | |
| 92 | RTCA17524 | TCA17524 | Idler Pulley - 5 in Flat Dia with .75 in Brg ID | 1 | |
| 93 | RM163058 | M127517, M163058 | Bushing - Sub For M127517 | 3 | |
| 94 | RM163053 | M134305, M163053 | Grass Deflector - Spindle | 3 | |
| 95 | RM123522 | M123522 | Washer - Belleville - Blade Bolt | 3 | |
| 97 | R19M7489 | 19M7489 | Bolt Hex HD - M16 x 45 Gr 10.9 | 3 | |
| 98 | RM133598 | M133598 | Shield | 2 | |
| 100 | RM136044 | M136044 | Spring - Extension | 1 | |
| 101 | RM141764 | M141764 | Eyebolt - Includes Flanged Locknut | 1 | |

All original equipment manufacturers names and part numbers are used for identification purposes only, and we are in no way implying that our products are original equipment parts. Prices subject to change without notice.