

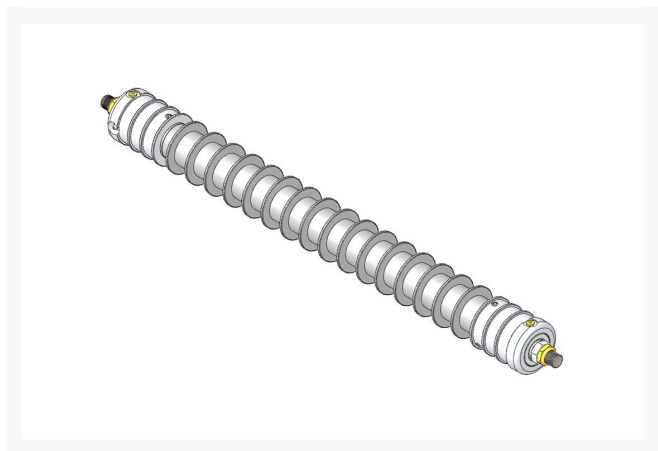

Roller - Grooved Repairable Steel

R601243R



Details

Constructed with a through shaft and greasable ball bearings. This roller can be repaired by unscrewing the ends and replacing the series of washers and spacers.

Replaces

R&R Products	R601243
--------------	---------

Specifications

Manufacturer	R&R Products
Overhaul Kit No.	R100135
Roller Body	3 in
Diameter	
Weight	20 lb

Fits Models

Brouwer 3/5/7 Gang Mower

Replacement Parts

R100135	Overhaul Kit - Roller
R600105	Shaft - Roller
R150673	Washer - 3 Repairable Roller
R150676	Spacer - 2-3/4 Dia x 1-1/4 L
R150678	Spacer - Grooved Roller 3/4
R150676A	Spacer - 1/8
R150675	Roller - End - 3 Threaded
R150691	Screw - Set Nyloc 3/8-16 x 3/8

Japan Equipment

123 Main St. Apartment 12 Tokyo, 100-0001
987-456-3210

<https://japan.rrproducts.com/>



Roller - Grooved Repairable Steel

R601243R



R170714	Fitting - Pressure Relief
R302-5	Fitting - Grease
R253-122	Seal
R254-79	Cup - Bearing
R254-78	Tapered Bearing Cone
R253-117	Seal - Outer Triple Lip
R150674	Sleeve - Wear 3/4 Plated
R3220-7	Nut - 3/4-16 Jam Zinc
R3296-15	Locknut - 3/4-16 Nylon Jam

Japan Equipment

123 Main St. Apartment 12 Tokyo, 100-0001
987-456-3210

<https://japan.rrproducts.com/>