

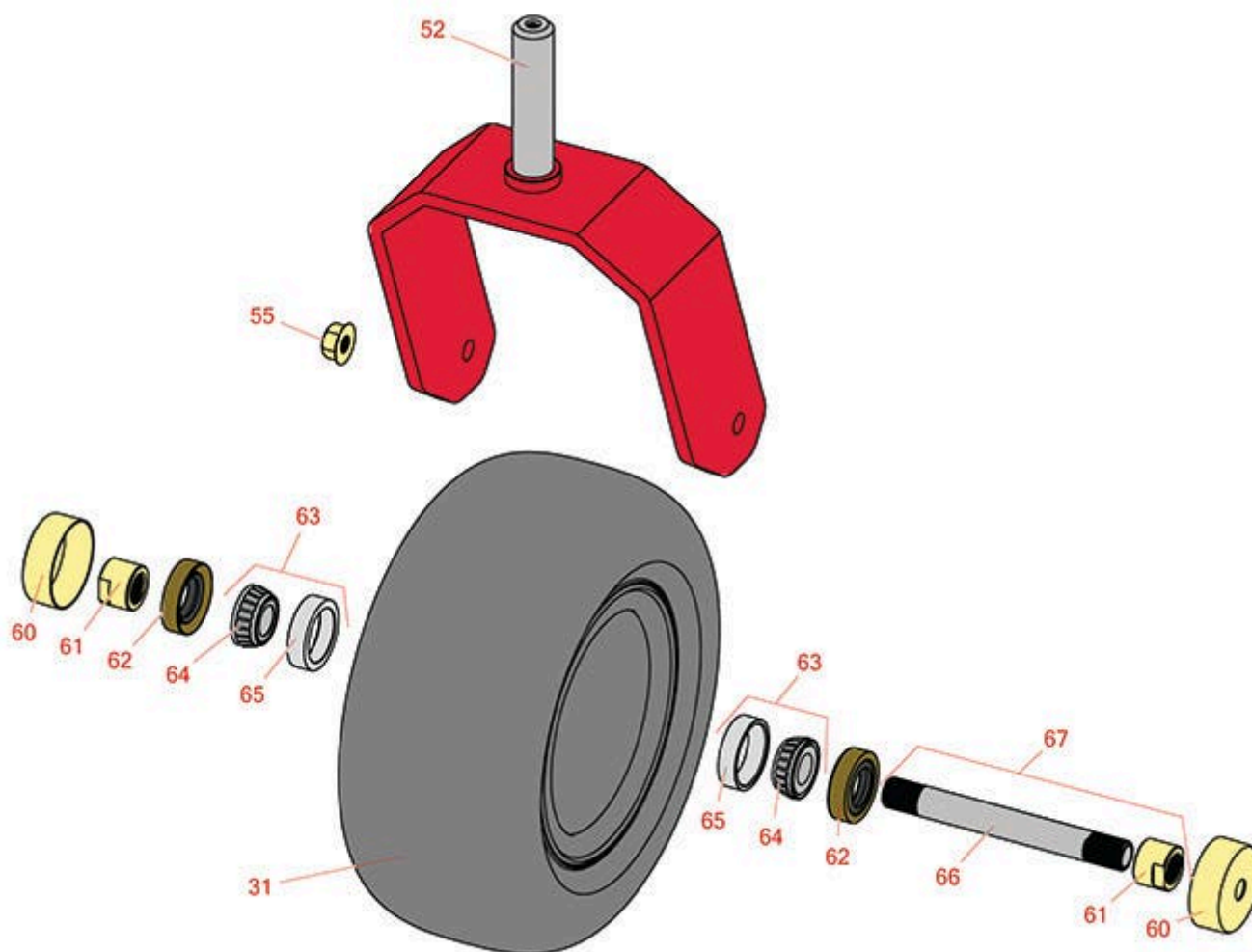

Replaces Exmark Radius X-Series Parts

52in Rotary Mower
Caster Wheel



All original equipment manufacturers names and part numbers are used for identification purposes only, and we are in no way implying that our products are original equipment parts. Prices subject to change without notice.



Replaces Exmark Radius X-Series Parts

52in Rotary Mower
Caster Wheel



Item No	R&R Part No.	OEM Part No.	Description	Qty Req	Order Quantity
---------	--------------	--------------	-------------	---------	----------------

Tires

31	RCT5121861	1-523009, 125-5581, 126-5959	Tire - 13x6.50-6 Nhs (4 Ply) Carlisle Smooth	2	
----	-------------------	------------------------------------	--	---	--

Tech Note: Only for RAX691GKA524A3:

Other Parts Available

52	R126-4312-01	126-4312-01	Fork - Caster	2	
----	---------------------	-------------	---------------	---	--

Tech Note: Only for RAX691GKA524A3:

55	R32128-23	32128-23, 99-5107	Nut - Lock Hex Flanged 1/2-13	2	
----	------------------	----------------------	-------------------------------	---	--

60	R103-2768	103-2768	Guard - Seal	4	
----	------------------	----------	--------------	---	--

61	R103-3051	103-3051	Spacer - Nut - Hardened	4	
----	------------------	----------	-------------------------	---	--

62	R103-0063	103-0063	Seal - Grease	4	
----	------------------	----------	---------------	---	--

63	R500534	1-633585, R & R ONLY	Bearing - with Cup	4	
----	----------------	-------------------------	--------------------	---	--

Detail Description: Kit includes: 1 ea R254-78- Bearing Cone & R254-79 Bearing Cone:

64	R254-78	1-633585	Tapered Bearing Cone	4	
----	----------------	----------	----------------------	---	--

65	R254-79	1-633584, R & R ONLY	Cup - Bearing	4	
----	----------------	-------------------------	---------------	---	--

Detail Description: Use R254-79M installation mandrel to properly install race.:

66	R126-5220	126-5220	Axle-Caster	2	
----	------------------	----------	-------------	---	--

67	R126-7796	126-7796	Caster Axle Assy	2	
----	------------------	----------	------------------	---	--

All original equipment manufacturers names and part numbers are used for identification purposes only, and we are in no way implying that our products are original equipment parts. Prices subject to change without notice.