

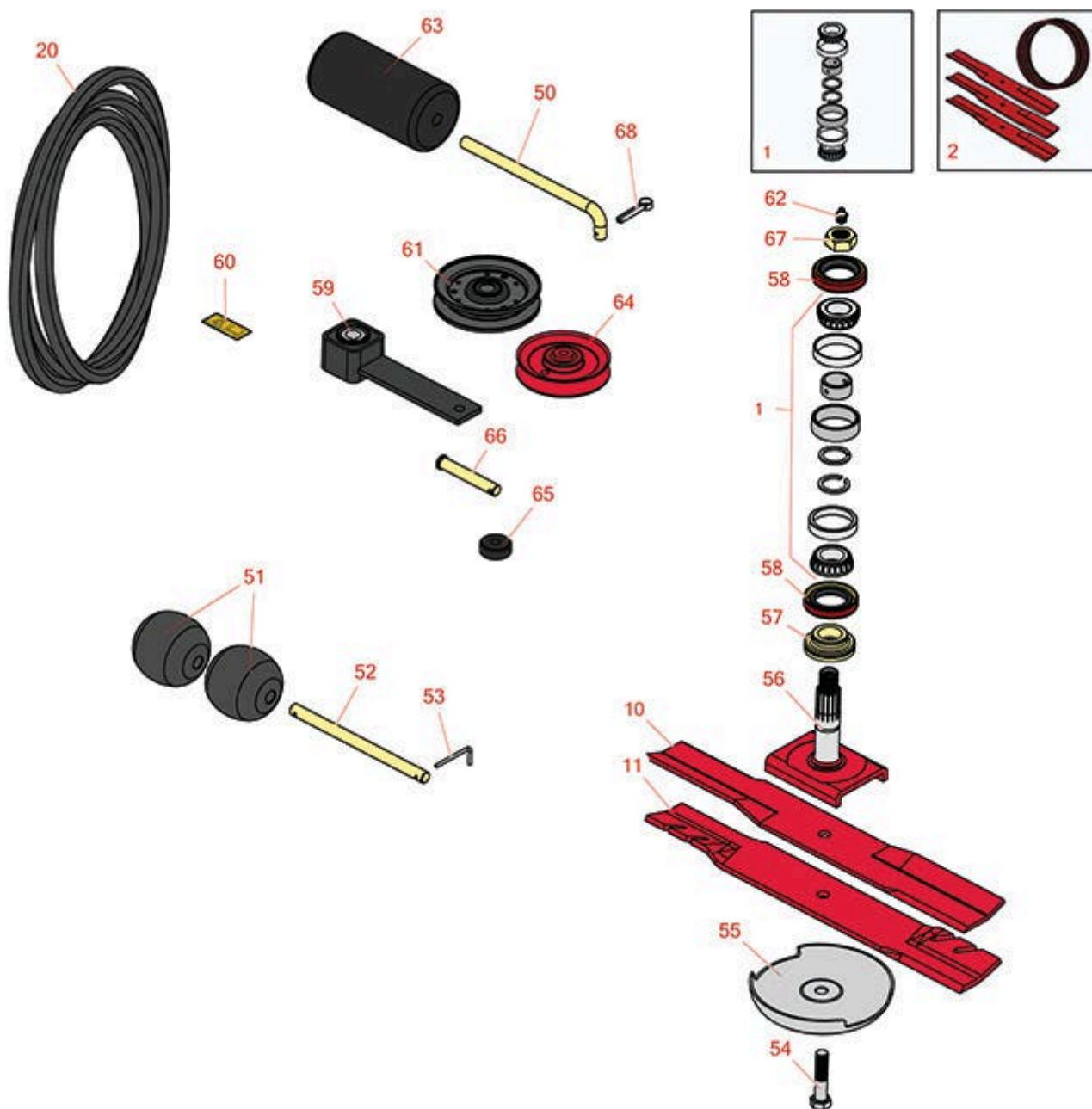

Replaces Toro Groundsmaster 3320

Parts

52in Rotary Deck - Model 30555
Deck Parts



All original equipment manufacturers names and part numbers are used for identification purposes only, and we are in no way implying that our products are original equipment parts. Prices subject to change without notice.



Replaces Toro Groundsmaster 3320

Parts

52in Rotary Deck - Model 30555

Deck Parts



Item No	R&R Part No.	OEM Part No.	Description	Qty Req	Order Quantity
---------	--------------	--------------	-------------	---------	----------------

Overhaul Kits

1	R46-8530	27-0960, 46-8530	Bearing - Set with Rings/Spacers	1	
---	-----------------	---------------------	----------------------------------	---	--

Detail Description: Includes 2 ea: R254-72 Bearings, R254-94 Cones, Spacers & Rings:

2	R95-3070	95-3070	Kit - Blade and Belt	1	
---	-----------------	---------	----------------------	---	--

Detail Description: Includes: 3 ea: R27-0990 Rotary Blades & 1 ea. R27-1160 Deck Belt.:

Blades

10	R27-0990	27-0990, 27-0990-03	Mower Blade - 18.00 Inch Standard	3	
----	-----------------	------------------------	--------------------------------------	---	--

11	R104-1301	104-1301	Mower Blade - Gator Mulcher	3	
----	------------------	----------	-----------------------------	---	--

Detail Description: Mulching mower blades increase efficiency and productivity. The patented Faltor mulching "teeth" circulate cut grass back into the deck multiple times creating a finer cut and better looking turf.:

11	R27-0990M	104-1301	Mower Blade - Gator Mulcher	3	
----	------------------	----------	-----------------------------	---	--

Detail Description: Mulching mower blades increase efficiency and productivity. The patented Faltor mulching "teeth" circulate cut grass back into the deck multiple times creating a finer cut and better looking turf.:

Belts

20	R150515	27-1160	Belt - Deck Gm 52	1	
----	----------------	---------	-------------------	---	--

Other Parts Available

50	R40-0340	40-0340	Shaft - Rear Roller	2	
----	-----------------	---------	---------------------	---	--

51	R29-4820	29-4820	Roller	2	
----	-----------------	---------	--------	---	--

52	R40-6400	40-6400	Shaft - Roller	1	
----	-----------------	---------	----------------	---	--

53	R57-0690	57-0690	Pin - Roller Shaft	1	
----	-----------------	---------	--------------------	---	--

54	R92-5816	92-5816	Bolt - Hex HD 1/2-20 x 2-1/4	3	
----	-----------------	---------	------------------------------	---	--

All original equipment manufacturers names and part numbers are used for identification purposes only, and we are in no way implying that our products are original equipment parts. Prices subject to change without notice.



Replaces Toro Groundsmaster 3320 Parts

52in Rotary Deck - Model 30555
Deck Parts



Item No	R&R Part No.	OEM Part No.	Description	Qty Req	Order Quantity
55	R72-9361	27-1000, 27-1001, 72-9360, 72-9361	Cup - Anti-Scalp	3	
56	R27-0920	27-0920	Spindle - Splined - 4-5/8 in	3	
57	R27-0950	27-0950	Spacer - Bearing	1	
58	R253-139	253-139	Seal - Spindle	2	
59	R27-8580	100-6178, 27-1060, 27-8580, 99-1297	Socket - Idler	1	
60	R93-6696	93-6696	Decal - Warning	2	
61	R65-5940	65-5940	Pulley - Idler	1	
62	R471219	30-8360, 302-2, 302-24, 302-31, 302-52	Zerk - Grease	1	
63	R36-1740	36-1740	Roller - Rotary Deck	2	
64	R52-4580	27-1080, 52-4580	Pulley - Idler	1	
65	R63-9750	63-9750, 64-9750	Mount - Rubber	4	
66	R283-55	283-55	Clevis Pin - 1/2 x 3	4	
67	R444742	32146-20, 9150906, 915090P	Nut - 3/4-16 Gripco Centerlock	1	

All original equipment manufacturers names and part numbers are used for identification purposes only, and we are in no way implying that our products are original equipment parts. Prices subject to change without notice.



Replaces Toro Groundsmaster 3320 Parts

52in Rotary Deck - Model 30555
Deck Parts

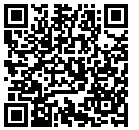

Item No	R&R Part No.	OEM Part No.	Description	Qty Req	Order Quantity
68	R3272-11	01-151-0010, 01-151-0040, 28-18-D, 28-28-D, 3211-72, 3272-11	Pin - Cotter	2	

All original equipment manufacturers names and part numbers are used for identification purposes only, and we are in no way implying that our products are original equipment parts. Prices subject to change without notice.